



● **Material**

Screws : M1.5 steel Zinc plated
 Contact : Phosphor bronze
 Pin header : Brass, Tin plated
 Housing : PBT, UL94V-0

● **Electrical**

Rated voltage : 300V
 Rated current : 8A
 Contact resistance : 20mΩ
 Insulation resistance: 5000MΩ/1000V
 Withstanding voltage: AC1500V/1Min
 Wire range : 26-18AWG 1mm²

● **Mechanical**

Temp.Range : -40°C~+105°C
 MAX Soldering: +250°C ,for 5 Sec.
 Torque : 0.15Nm(1.3lb.in)
 Strip length : 3.7-4.7mm

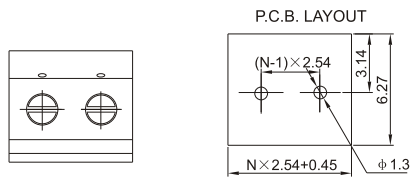
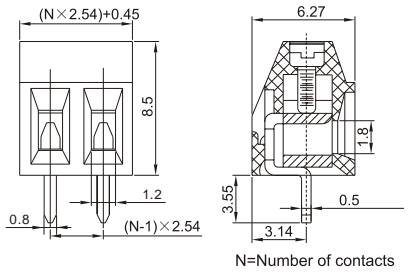

Pitch:2.54mm