

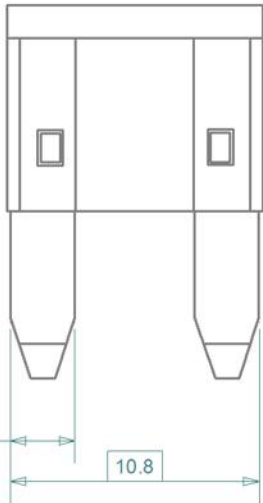

11.1

3.9



2.8

10.8

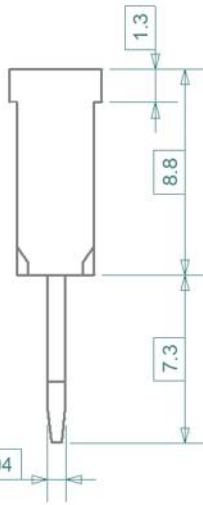

1.3

8.8

7.3

0.82 ± 0.04

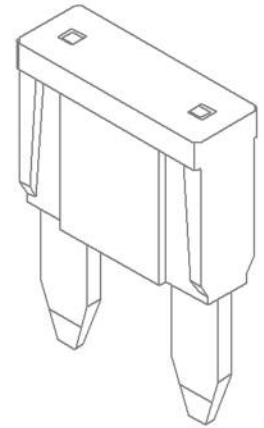

3D not to scale

Rating [ A ]	Color	Volt [ V ]	iMaXX Reference
1	Black	32	F7001 *
2	Grey	32	F7002
3	Violet	32	F7003
4	Pink	32	F7004
5	Tan	32	F7005
7.5	Brown	32	F7075
10	Red	32	F7010
15	Blue	32	F7015
20	Yellow	32	F7020
25	Natural	32	F7025
30	Green	32	F7030

\* ISO 8820-3, 135% load not applicable for this rating

Fusing time DIN ISO 8820-3 [s]		
Load [%]	Minimum [s]	Maximum [s]
110 %	360,000	-
135 %	0.75	600
160 %	0.25	50
200 %	0.15	5
350 %	0.04	0.5
600 %	0.02	0.1

Revisions			Date	Appr.
	Date	Type	Drawn	02/99 GRH
a	11/99	add 3 & 4A	Checked	06/19 EB
b	06/01	DIN nomenclature	Standards	
c	05/03	OCR printing	Approved	06/19 AdH
d	06/07	re-drawn		
e	07/11	updated DIN to ISO	Scale 3 : 1	
f	03/12	updated dimensions	Projection	Tolerance
g	10/12	updated dimensions		± 0.2 mm unless otherwise noted
h	12/15	updated fuse markings		
i	06/19	added 1 & 2A		



Title	F7000 series, miniOTO blade fuse
Drawing type	schematic
Drawing number	F7000 drawing 1
Sheet	1 of 1
Layers	0 1 2 6 9 11

1

2

3

4