



# SX82



**TYPICAL APPLICATIONS** Coffee machines, refrigerators, ironing steam generators, medical appliances, vacuum cleaners, power inlet

- FUNCTIONS**
- SPST, illuminated or not
  - DPST, momentary or not
  - DPST, illuminated or not
  - DPCO
  - DPDT

**CYCLE No.** 50.000

**CUT OUT** 30x22 mm

**AMBIENT TEMPERATURE** 125 °C

**GWT** 850 °C

**GWT NO FLAME (<2sec)** 750 °C on demand

S X 8 2 ?

## DRAWING

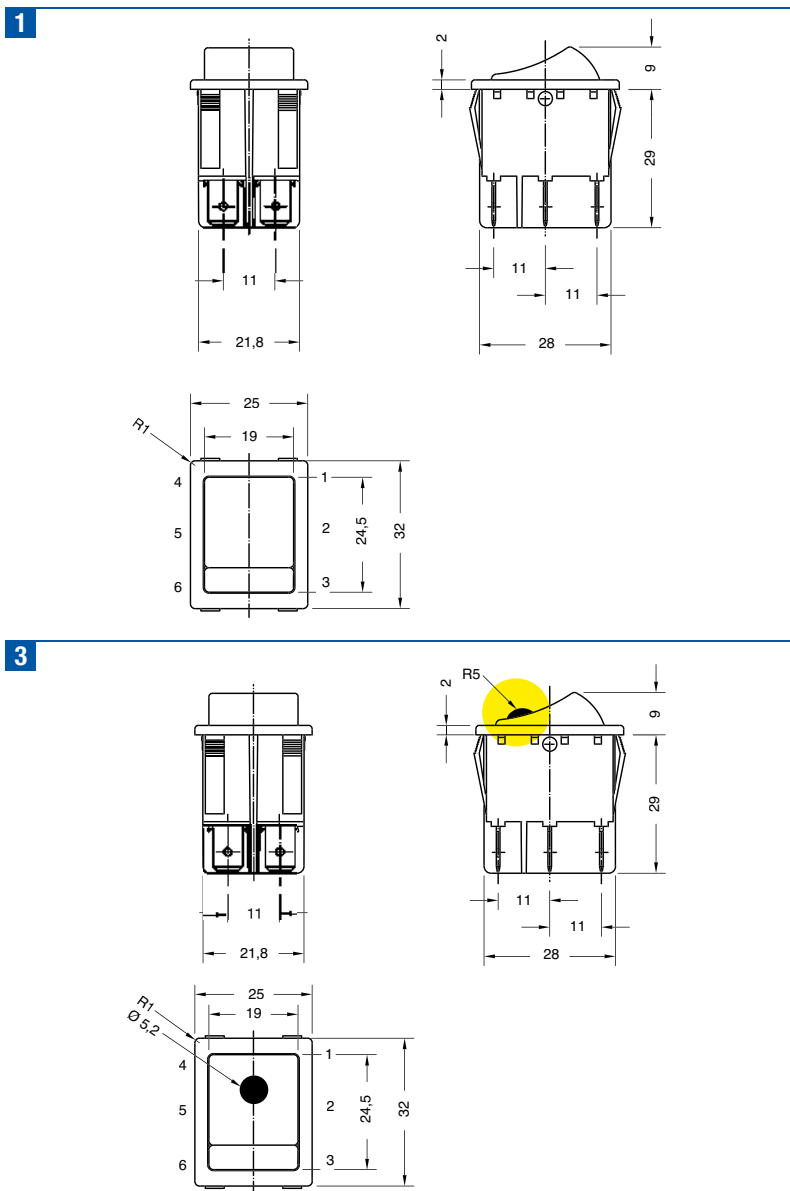

?

## TERMINAL

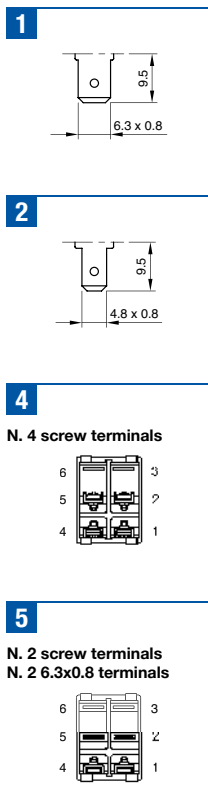

WATERPROOF CAP

**P** (1 + waterproof cap mounted)

**Q** (3 + waterproof cap mounted)

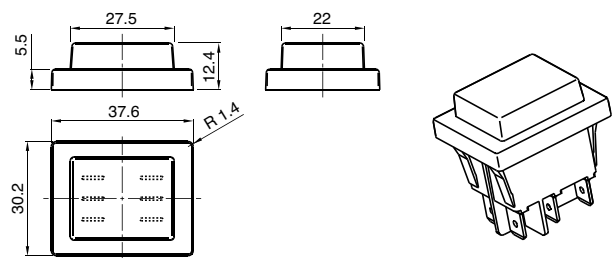

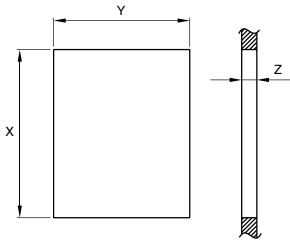

		Z	Y	X
<b>STANDARD</b>	PLASTIC	0,7 ... 3,5	22 ±0,1	30 +0,2 0
<b>WATERPROOF CAP VERSION</b>	METAL	0,7 ... 2,5	22 ±0,1	30,2 +0,2 0

DRAWING	TERMINAL	FUNCTION	RATING	BODY COLOUR	ROCKER COLOUR	MARKING COLOUR	MARKING	LENS COLOUR			
S	X	8	2						0	0	0

?	?	?	?	?	?	?	?	0	0	0
FUNCTION	RATING	BODY COLOUR	ROCKER COLOUR	MARKING COLOUR	MARKING	LENS COLOUR				

**1** Terminal 1 - 2



**2**

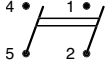

**7** Terminal 1

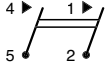

**8**

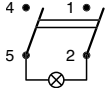

**9** Terminal 1

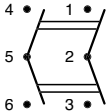

**L** Terminal 1

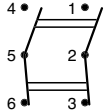

**W** Terminal 1

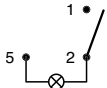

**8**

**Function 1 - 2**  
 20 (2) A / 250 VAC \*  
 16 (8) A / 250 VAC  
 10 (6) A / 250 VAC - 5E4  
 10 (4) A / 400 VAC  
 T125/55 °C  
 EN 61058

20 A / 125 VAC  
 16 A / 250 VAC  
 3/4 HP - 125 / 250 VAC  
 T105 °C  
 UL 1054

**Function 7 - L**  
 16 (6) A / 250 VAC  
 10 (4) A / 400 VAC  
 10 (4) A / 250 VAC - 5E4  
 T125/55 °C  
 EN 61058

20 A / 125 VAC  
 16 A / 250 VAC  
 3/4 HP - 125 / 250 VAC  
 T105 °C  
 UL 1054

**Function 8 - W**  
 20 (2) A / 250 VAC \*  
 16 (8) A / 250 VAC  
 10 (6) A / 250 VAC - 5E4  
 T125/55 °C  
 EN 61058

20 A / 125 VAC  
 16 A / 250 VAC  
 3/4 HP - 125 / 250 VAC  
 T105 °C  
 UL 1054

**Function 9**  
 16 (6) A / 250 VAC  
 10 (4) A / 250 VAC - 5E4  
 T125/55 °C  
 EN 61058

16 A / 125 VAC  
 16 A / 250 VAC  
 3/4 HP - 125 / 250 VAC  
 T105 °C  
 UL 1054

**B**

**Function 8 - W**  
 20 (2) A / 250 VAC \*  
 16 (8) A / 250 VAC  
 10 (6) A / 250 VAC - 5E4  
 T125/55 °C  
 EN 61058

16 A / 250 VAC  
 3/4 HP - 250 VAC  
 T105 °C  
 UL 1054

\* Not available for terminal 2

**1** black

**2** white

**X** custom

**1** black

**2** white

**ILLUMINATED**

**G** red

**H** orange

**E** green

**L** white

**F** blue

**X** custom

**1** black

**2** white

**0** none

**X** custom

**1**

**2**

**6**

**9**

**A**

**C**

**D**

**N**

**0**

**X**

**0** none

**ILLUMINATED**

**G** red

**H** orange

**E** green

**X** custom